

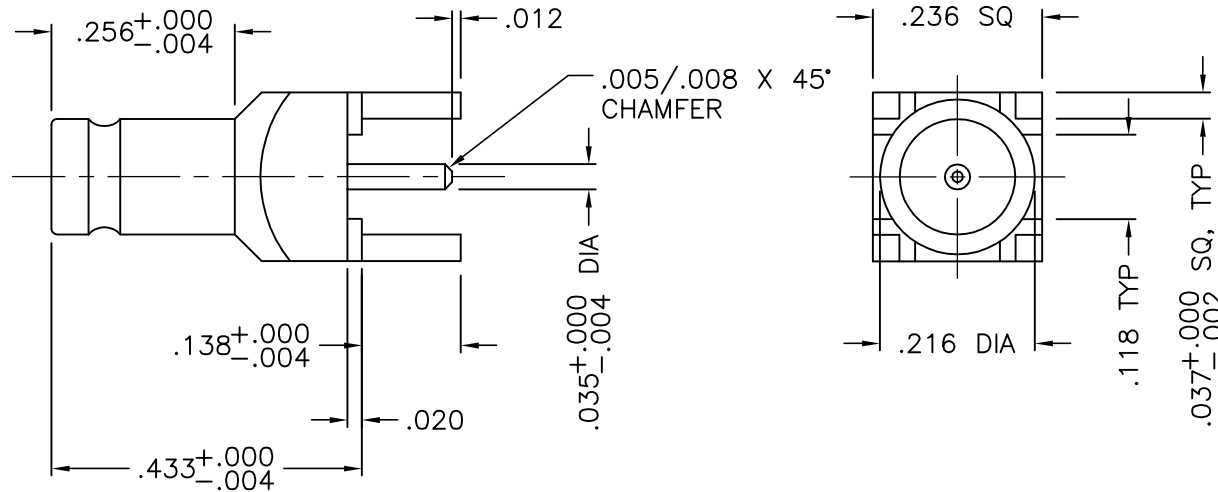

4267-000-G91P-1



NOTES:

- MATERIAL: CONTACT - BERYLLIUM COPPER PER ASTM B196.
INSULATOR - TEFLON PER ASTM D1710
BODY - BRASS PER ASTM B16
- FINISHES: ALL METAL PARTS - GOLD PLATE PER MIL-G-45204

UNLESS OTHERWISE SPECIFIED: TOLERANCES: 3 PLACES = ±.005, 2 PLACES = ±.02, ANGLES = ±1/2°, SURFACE FINISH = 63

| | | |
|------|-----------|---------|
| - | OUTLINE | 6/17/02 |
| ALT. | REVISIONS | DATE |

DELTA ELECTRONICS MFG. CORP. Beverly, MA 01915

TITLE:
1.0/2.3 QUICK-DISCONNECT P.C.B. MOUNT
JACK RECEPTACLE - POST CONTACT

| | | | | |
|----------------------------|--------------|---------|-----------|--------------------------------|
| Drawn by BJM 6/17/02 | Scale 4/1 | Ckd. by | Engr Appd | FILE NAME: 4267000G91P-001T |
|----------------------------|--------------|---------|-----------|--------------------------------|

THESE DRAWINGS AND SPECIFICATIONS ARE THE PROPERTY OF DELTA ELECTRONICS MFG CORP. AND SHALL NOT BE REPRODUCED, OR COPIED OR USED AS THE BASIS FOR THE MANUFACTURE OR SALE OF APPARATUS OR DEVICES WITHOUT THEIR EXPRESS WRITTEN CONSENT.

CODE IDENT.-00795

4267-000-G91P-1