

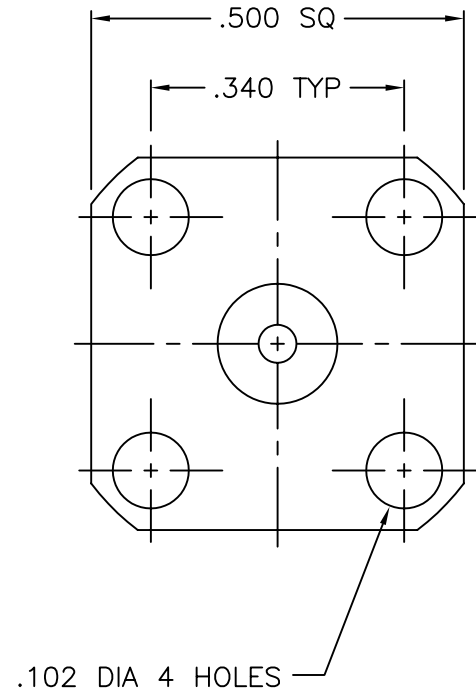

1359-000-K051-4

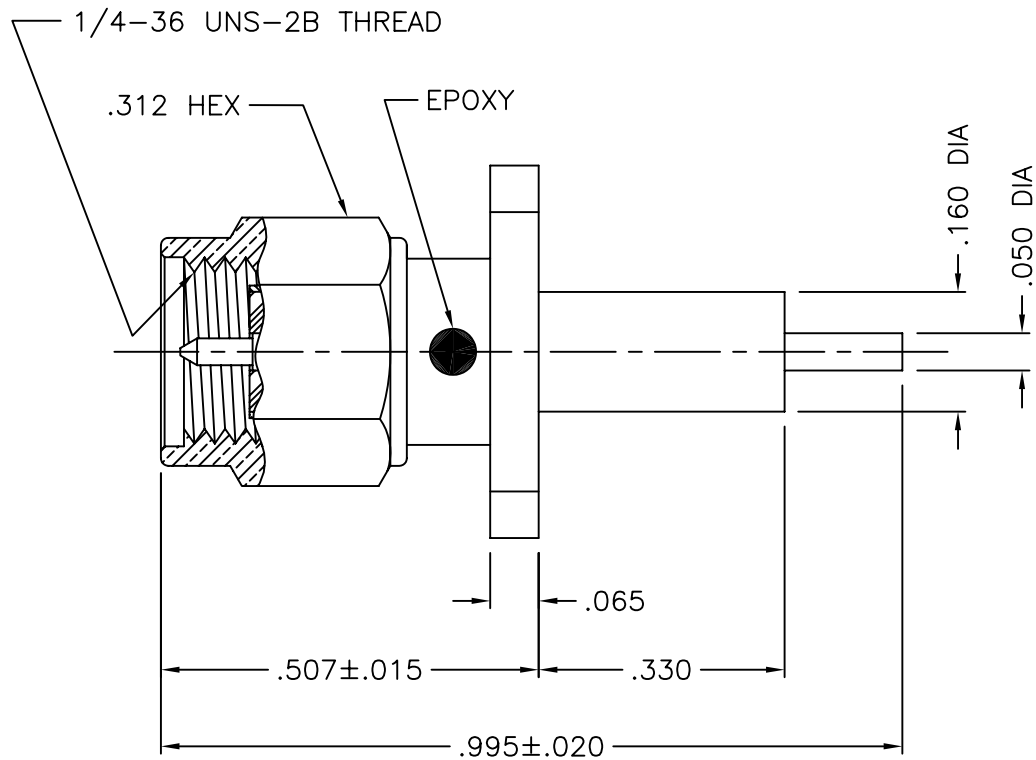

NOTES:

1. ASSEMBLED CONNECTOR INTERFACE IS DESIGNED IN ACCORDANCE WITH MIL-STD-348.
2. MATERIAL: BODY & COUPLING NUT- CORROSION RESISTANT STEEL PER ASTM A582
 CONTACT- BRASS PER ASTM B16.
 GASKET- SILICONE RUBBER PER ZZ-R-765
 INSULATOR- TEFLON PER ASTM D1710
3. FINISHES: BODY & COUPLING NUT- PASSIVATE PER QQ-P-35
 CONTACT- GOLD PLATE PER MIL-G-45204

UNLESS OTHERWISE SPECIFIED: TOLERANCES: 3 PLACES = ±.005, 2 PLACES = ±.02, ANGLES = ±1/2°, SURFACE FINISH = 63

-	OUTLINE	3/23/07
ALT.	REVISIONS	DATE

DELTA ELECTRONICS MFG. CORP. Beverly, MA 01915					
TITLE: 'SMA' PANEL MOUNT PLUG RECEPTACLE - POST CONTACT					
Drawn by DG	Scale 4/1	Ckd. by MR	Engr Appd MR	FILE NAME: 1359000K051-004T	
3/23/07					

THESE DRAWINGS AND SPECIFICATIONS ARE THE PROPERTY OF DELTA ELECTRONICS MFG CORP. AND SHALL NOT BE REPRODUCED, OR COPIED OR USED AS THE BASIS FOR THE MANUFACTURE OR SALE OF APPARATUS OR DEVICES WITHOUT THEIR EXPRESS WRITTEN CONSENT.

CODE IDENT.-00795 1359-000-K051-4