

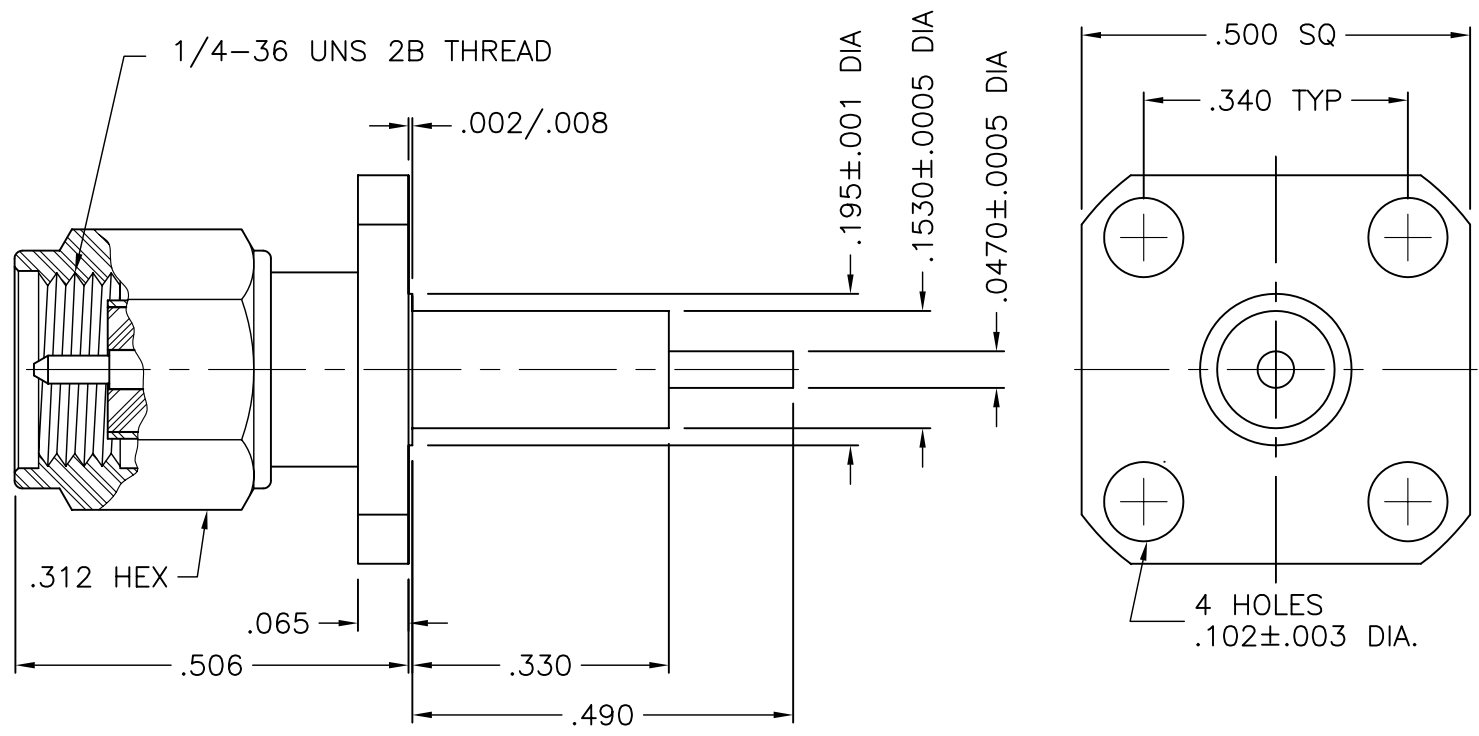

1359-000-G051-900



**NOTES:**

1. ASSEMBLED CONNECTOR INTERFACE IS DESIGNED IN ACCORDANCE WITH MIL-STD-348.
2. MATERIAL: BODY, BUSHING & C'NUT- CORROSION RESISTANT STEEL PER ASTM A582  
INSULATOR - TEFLON PER ASTM D1710  
CONTACT & LOCKING RING - BERYLLIUM COPPER PER ASTM B196.  
GASKET - SILICONE RUBBER PER ZZ-R-765
3. FINISHES: BODY, CONTACT, BUSHING & C'NUT - GOLD PLATE PER MIL-G-45204

DELTA ELECTRONICS MFG. CORP. Beverly, MA 01915					
TITLE: 'SMA' HIGH FREQUENCY PANEL MOUNT PLUG RECEPTACLE - EXTENDED TEFLON & POST CONTACT					
Drawn by MCD 12/7/05	Scale 4/1	Ckd. by MR	Engr Appd MR	FILE NAME: 1359000G051-900T	
CODE IDENT: -00795			1359-000-G051-900		

UNLESS OTHERWISE SPECIFIED: TOLERANCES: 3 PLACES = ±.005, 2 PLACES = ±.02, ANGLES = ±1/2°, SURFACE FINISH = 63	-	OUTLINE	12/7/05
	ALT.	REVISIONS	DATE

THESE DRAWINGS AND SPECIFICATIONS ARE THE PROPERTY OF DELTA ELECTRONICS MFG CORP. AND SHALL NOT BE REPRODUCED, OR COPIED OR USED AS THE BASIS FOR THE MANUFACTURE OR SALE OF APPARATUS OR DEVICES WITHOUT THEIR EXPRESS WRITTEN CONSENT.