

1320-000-G911-78

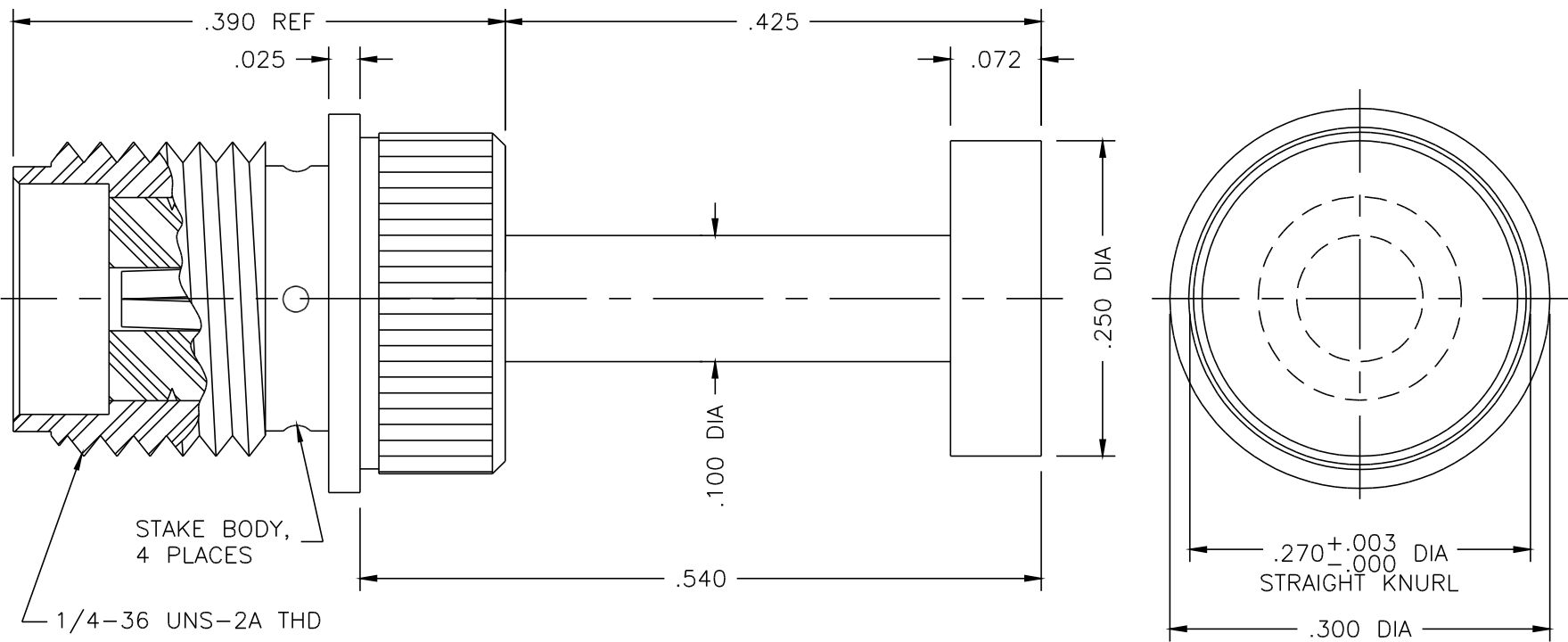

NOTES:

1. ASSEMBLED CONNECTOR INTERFACE IS DESIGNED IN ACCORDANCE WITH MIL-STD-348.
2. MATERIAL: BODY - STAINLESS STEEL PER ASTM A582
CONTACT - BRASS PER ASTM B196
INSULATOR - TEFLON PER ASTM D1710
3. FINISHES: CONTACT & BODY - GOLD PLATE PER MIL-G-45204

UNLESS OTHERWISE SPECIFIED: TOLERANCES: 3 PLACES = ±.005, 2 PLACES = ±.02, ANGLES = ±1/2°

-	OUTLINE	6/2/00
ALT.	REVISIONS	DATE

DELTA ELECTRONICS MFG. CORP. Beverly, MA 01915				
TITLE: 'SMA' PRESS MOUNT JACK RECEPTACLE - PROBE CONTACT				
Drawn by BJM 6/2/00	Scale 8/1	Ckd. by	Engr Appd	FILE NAME: 1320000G911-078T
CODE IDENT.-00795		1320-000-G911-78		

THESE DRAWINGS AND SPECIFICATIONS ARE THE PROPERTY OF DELTA ELECTRONICS MFG CORP. AND SHALL NOT BE REPRODUCED, OR COPIED OR USED AS THE BASIS FOR THE MANUFACTURE OR SALE OF APPARATUS OR DEVICES WITHOUT THEIR EXPRESS WRITTEN CONSENT.