

1320-000-G911-76

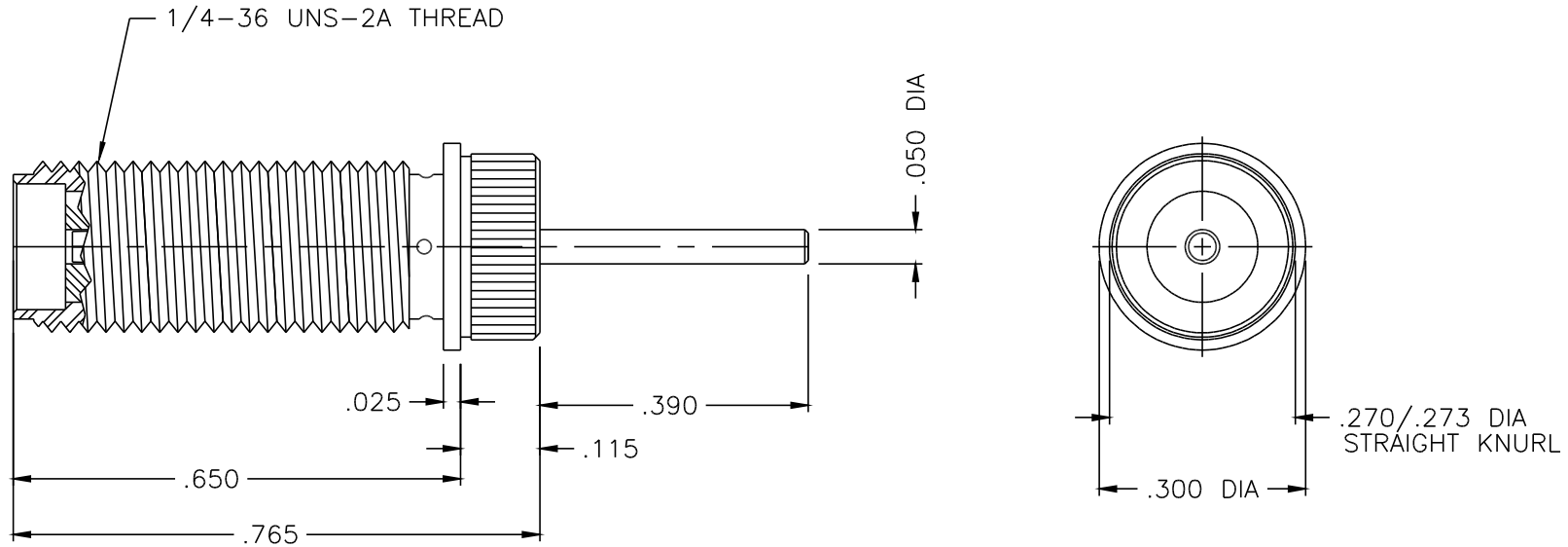

NOTES:

- ASSEMBLED CONNECTOR INTERFACE IS DESIGNED IN ACCORDANCE WITH MIL-STD-348.
- MATERIAL: BODY - BRASS PER ASTM B16.  
CONTACT - BERYLLIUM COPPER PER ASTM B196.  
INSULATOR - TEFLON PER ASTM D1710
- FINISHES: BODY - GOLD PLATE PER MIL-G-45204  
CONTACT - GOLD PLATE PER MIL-G-45204

RFS NEW JERSEY

DELTA ELECTRONICS MFG. CORP. Beverly, MA 01915				
TITLE: 'SMA' (F) PRESSMOUNT JACK RECEPTACLE - EXTENDED BODY - POST CONTACT				
Drawn by MR	Scale 8/1	Ckd. by	Engr Appd	FILE NAME: 1320000G911-076T
3/24/00				
CODE IDENT.-00795		1320-000-G911-76		

UNLESS OTHERWISE SPECIFIED: TOLERANCES: 3 PLACES = ±.005, 2 PLACES = ±.02, ANGLES = ±1/2°

THESE DRAWINGS AND SPECIFICATIONS ARE THE PROPERTY OF DELTA ELECTRONICS MFG CORP. AND SHALL NOT BE REPRODUCED, OR COPIED OR USED AS THE BASIS FOR THE MANUFACTURE OR SALE OF APPARATUS OR DEVICES WITHOUT THEIR EXPRESS WRITTEN CONSENT.

-	OUTLINE	3/24/00
ALT.	REVISIONS	DATE