

1313-000-G051-500



1/4-36 UNS-2A THREAD

.102 DIA 4 HOLES

.050±.001 DIA

.037 DIA

STAKED
4 PLACES

.065

.375

.575±.020

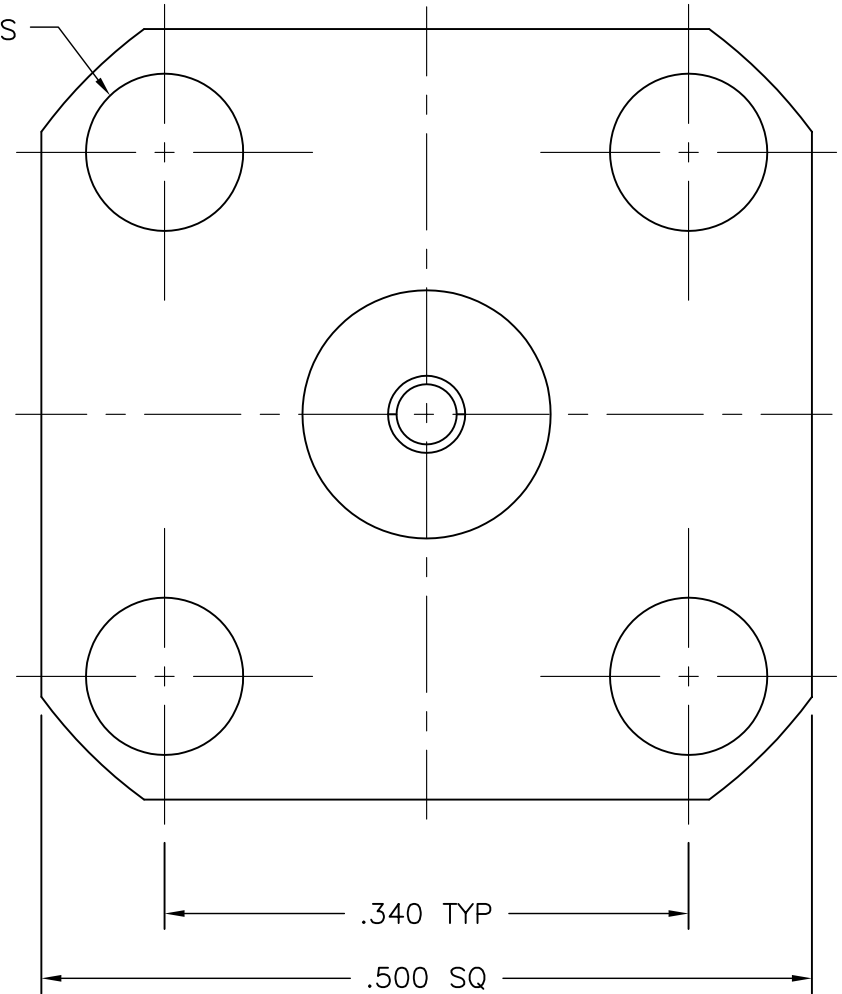

NOTES:

1. ASSEMBLED CONNECTOR INTERFACE IS DESIGNED IN ACCORDANCE WITH MIL-STD-348.
2. MATERIAL: BODY - BRASS PER ASTM B16
CONTACT - BERYLLIUM COPPER PER ASTM B196.
INSULATOR - TEFLON PER ASTM D1710
3. FINISHES: BODY - GOLD PLATE PER MIL-G-45204
CONTACT - GOLD PLATE PER MIL-G-45204

UNLESS OTHERWISE SPECIFIED: TOLERANCES: 3 PLACES = ±.005, 2 PLACES = ±.02, ANGLES = ±1/2°, SURFACE FINISH = 63

-	OUTLINE	11/18/05
ALT.	REVISIONS	DATE

DELTA ELECTRONICS MFG. CORP. Beverly, MA 01915

TITLE: SMA PANEL MOUNT JACK RECEPTACLE
- SOLDER POT CONTACT, MECHANICALLY CAPTIVE

Drawn by BJM 11/18/05	Scale 8/1	Ckd. by MR	Engr Appd MR	FILE NAME: 1313000G051-500T
-----------------------------	--------------	---------------	-----------------	--------------------------------

THESE DRAWINGS AND SPECIFICATIONS ARE THE PROPERTY OF DELTA ELECTRONICS MFG CORP. AND SHALL NOT BE REPRODUCED, OR COPIED OR USED AS THE BASIS FOR THE MANUFACTURE OR SALE OF APPARATUS OR DEVICES WITHOUT THEIR EXPRESS WRITTEN CONSENT.

CODE IDENT.-00795

1313-000-G051-500