

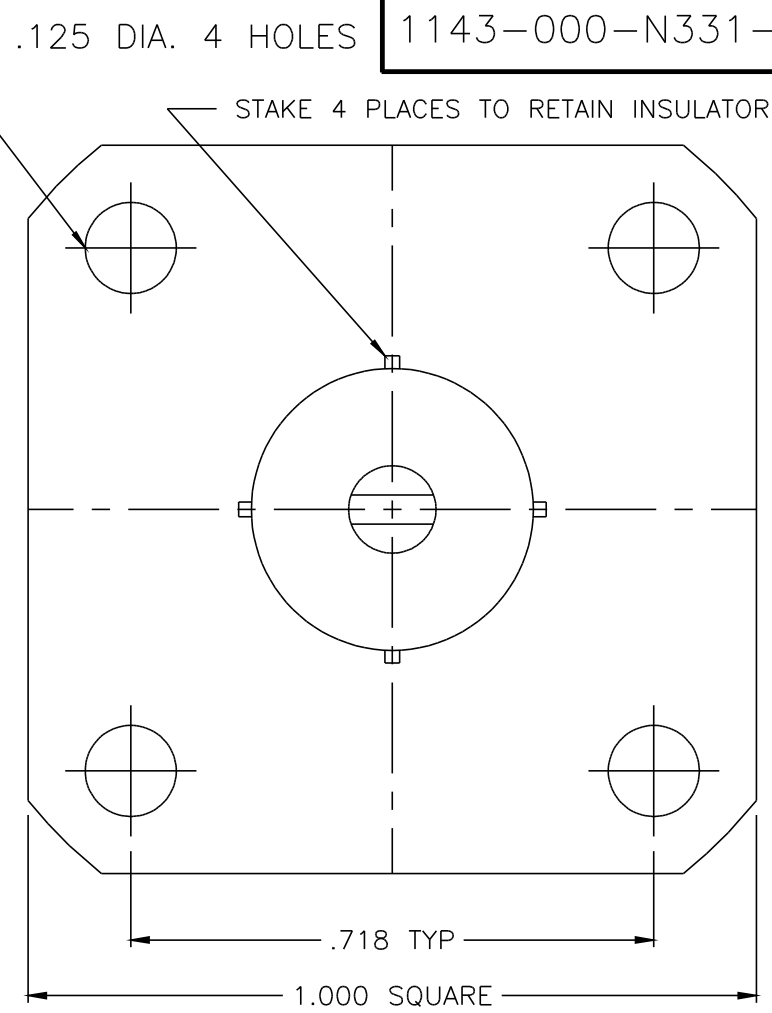

1143-000-N331-54

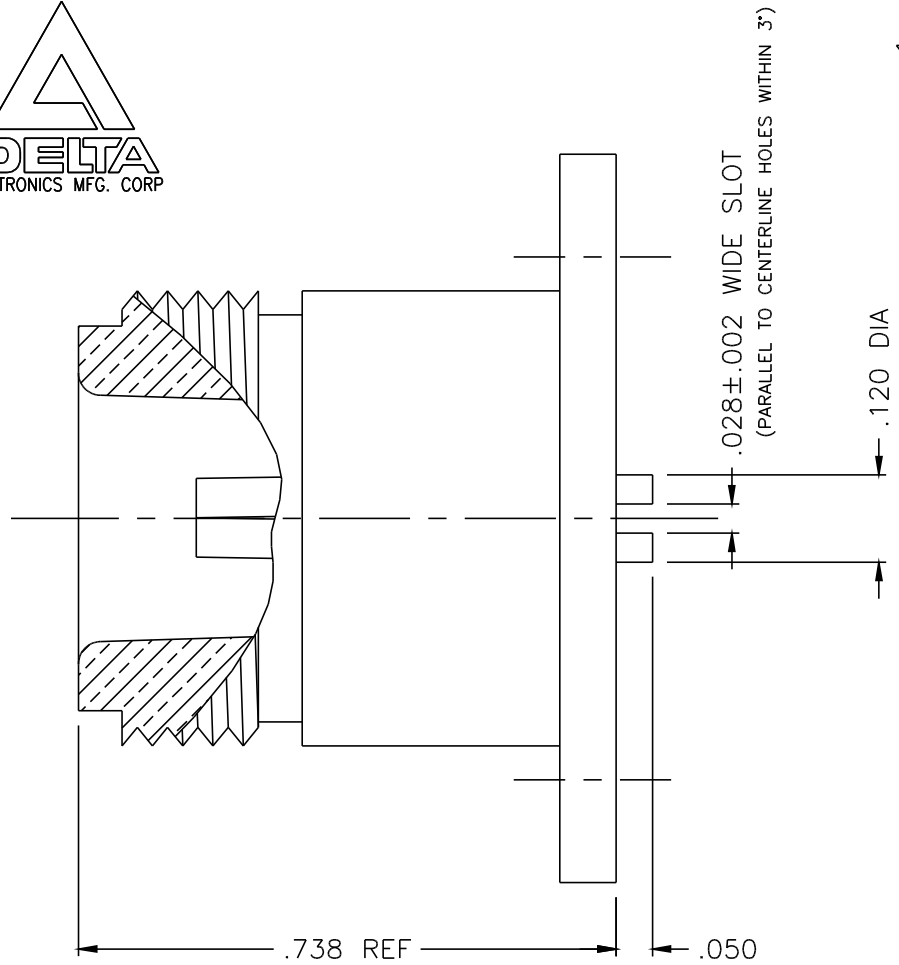

NOTES:

1. ASSEMBLED CONNECTOR INTERFACE IS DESIGNED IN ACCORDANCE WITH MIL-STD-348.
2. MATERIAL: BODY (1 PIECE) - BRASS PER ASTM B16
CONTACT - BERYLLIUM COPPER PER ASTM B196.
INSULATOR - TEFLON PER ASTM D1710
3. FINISHES: BODY - NICKEL PLATE .0002 MIN. PER QQ-N-290
CONTACTS - GOLD PLATE .00003 MIN. PER MIL-G-45204 OVER
NICKEL PLATE .00005 MIN. PER QQ-N-290
4. CONTACT TO WITHSTAND 6 LB. MIN. AXIAL FORCE

ALT.	REVISIONS	DATE
-	OUTLINE	6/27/97

DELTA ELECTRONICS MFG. CORP. Beverly, MA 01915

TITLE: "N"(F) PANEL MOUNT RECEPT. - MECH. CAPTIVE SLOTTED CONTACT

Drawn by MJA 6/27/97	Scale 4/1	Ckd. by	Engr Appd	FILE NAME: 1143000N331-054T
----------------------------	--------------	---------	-----------	--------------------------------

UNLESS OTHERWISE SPECIFIED: TOLERANCES: 3 PLACES = ±.005, 2 PLACES = ±.02, ANGLES = ±1/2°

THESE DRAWINGS AND SPECIFICATIONS ARE THE PROPERTY OF DELTA ELECTRONICS MFG CORP. AND SHALL NOT BE REPRODUCED, OR COPIED OR USED AS THE BASIS FOR THE MANUFACTURE OR SALE OF APPARATUS OR DEVICES WITHOUT THEIR EXPRESS WRITTEN CONSENT.

CODE IDENT. -00795 1143-000-N331-54