

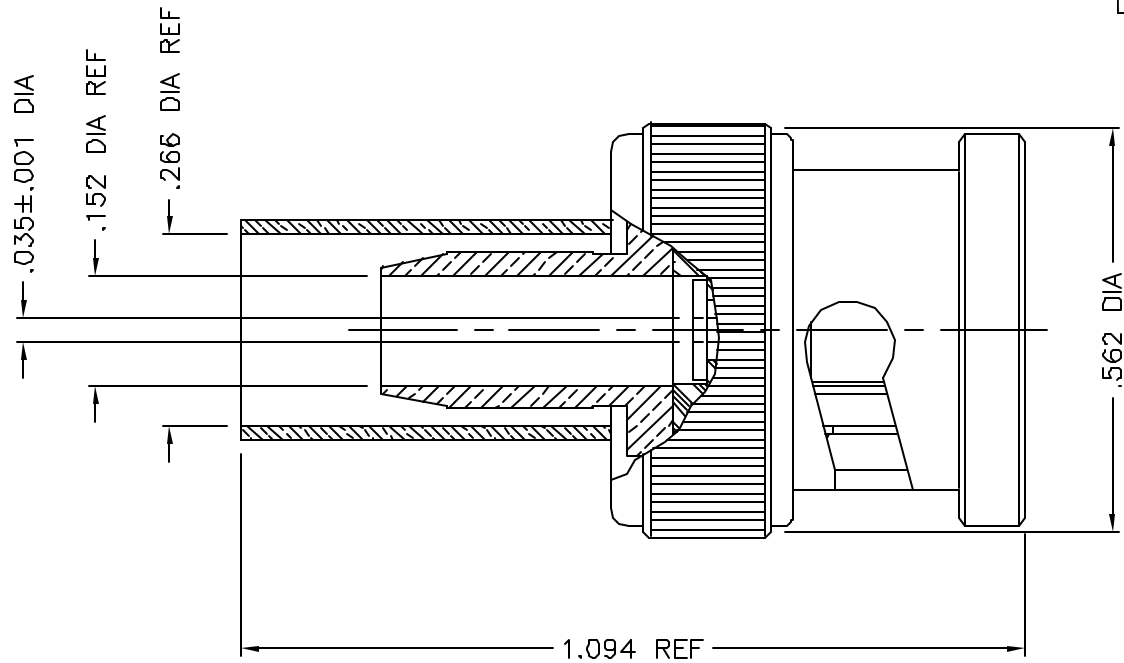

1003-020-N001-005



NOTES:

- ASSEMBLED CONNECTOR INTERFACE IS DESIGNED IN ACCORDANCE WITH MIL-STD-348.
- MATERIAL:** BODY & WASHER - BRASS PER ASTM B16
 CONTACT & CONTACT FINGERS - BRASS PER ASTM B16
 INSULATOR - TEFLON PER ASTM D1710
 CRIMP SLEEVE - D.H.P. COPPER CDA ALLOY 122
 BAYONET SLEEVE - BRASS PER ASTM B16
 SPRING WASHER - BERYLLIUM COPPER PER ASTM B196
 FLAT GASKET - SILICONE RUBBER PER ZZ-R-765
- FINISHES:** SPRING WASHERS - NICKEL PLATE PER QQ-N-290
 CONTACT - GOLD PLATE PER MIL-G-452D4
 CRIMP SLEEVE - SULFAMATE NICKEL PLATE PER MIL-P-27418
 ALL OTHER METAL PARTS - NICKEL PLATE PER QQ-N-290
- USE PALADIN #PA 1815 CRIMP TOOL AS SUPPLIED BY LINTON ASSOCIATES LTD.
 P.O. BOX 189, COLLEGEVILLE, PA 19426 OR TOOL CT44-000 WITH DIE DT44-13
 OR TOOL ATCC5 AS SUPPLIED BY AUTOMATIC TOOL & CONNECTOR CO.

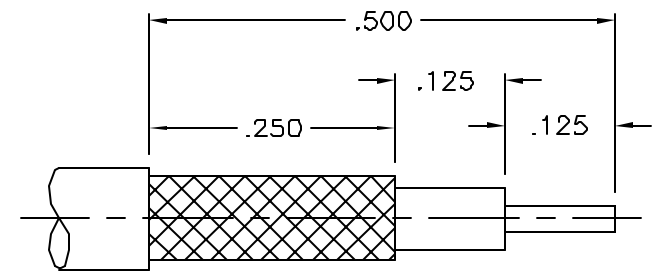

CABLE CUTTING DIMENSIONS

DELTA ELECTRONICS MFG. CORP. Beverly, MA 01915

TITLE: BNC' CRIMP PLUG FOR RG-59, 71, 140, 210 & 59/U CABLES - NON CAPTIVE CONTACT

Drawn by STM	Scale 4/1	Ckd. by	Engr Appd	FILE NAME: 1003020N001-005T
-----------------	--------------	---------	-----------	--------------------------------

CODE IDENT. -00795 1003-020-N001-005

UNLESS OTHERWISE SPECIFIED: TOLERANCES: 3 PLACES = ±.000, 2 PLACES = ±.02, ANGLES = ±1/2°

-	OUTLINE	8/8/05
ALT.	REVISIONS	DATE

THESE DRAWINGS AND SPECIFICATIONS ARE THE PROPERTY OF DELTA ELECTRONICS MFG CORP. AND SHALL NOT BE REPRODUCED, OR COPIED OR USED AS THE BASIS FOR THE MANUFACTURE OR SALE OF APPARATUS OR DEVICES WITHOUT THEIR EXPRESS WRITTEN CONSENT.