

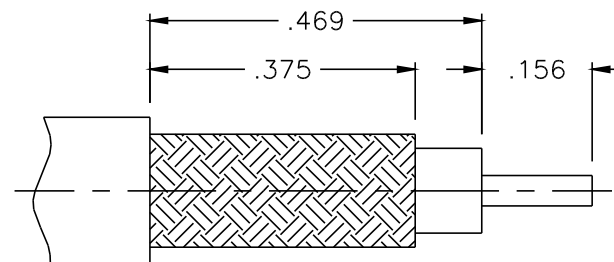

1003-005-N000

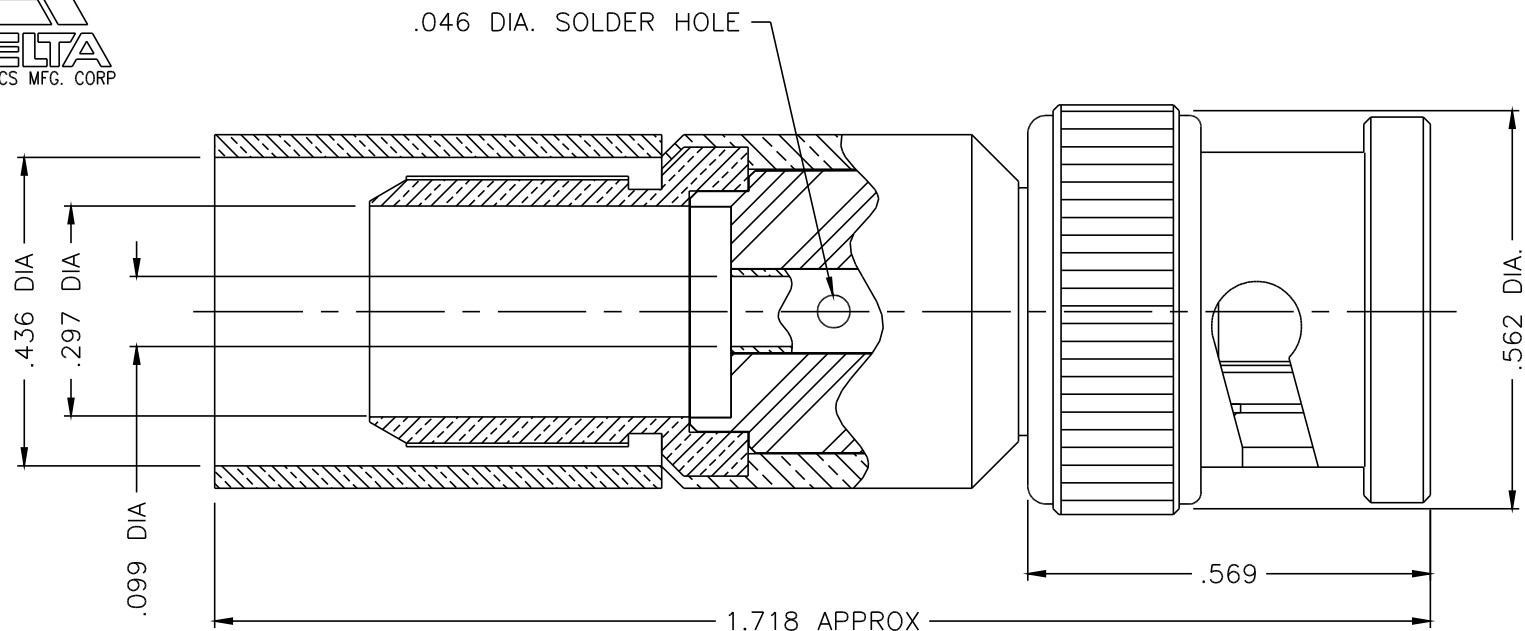

RECOMMENDED CABLE CUTTING DIMENSIONS

NOTES:

1. ASSEMBLED CONNECTOR INTERFACE IS DESIGNED IN ACCORDANCE WITH MIL-STD-348.
2. MATERIAL: SPRING WASHER - BERYLLIUM COPPER PER ASTM B196.  
INSULATOR - TEFLON PER ASTM D1710  
CRIMP SLEEVE - D.H.P. COPPER CDA ALLOY 122  
ALL OTHER METAL PARTS - BRASS PER ASTM B16
3. FINISHES: CONTACT - GOLD PLATE PER MIL-G-45204  
ALL OTHER PLATED PARTS - NICKEL PLATE PER QQ-N-290

UNLESS OTHERWISE SPECIFIED: TOLERANCES: 3 PLACES =  $\pm 0.005$ , 2 PLACES =  $\pm 0.02$ , ANGLES =  $\pm 1/2^\circ$

A	REDRAWN RWP	10/24/97
-	OUTLINE	8/23/97
ALT.	REVISIONS	DATE

DELTA ELECTRONICS MFG. CORP. Beverly, MA 01915				
TITLE: 'BNC' (M) CRIMP PLUG FOR RG-214 CABLE NON-CAPTIVE CONTACT				
Drawn by RWP	Scale 4/1	Ckd. by	Engr Appd	FILE NAME: 1003005N000-000T
10/24/97				
CODE IDENT.-00795		1003-005-N000		

THESE DRAWINGS AND SPECIFICATIONS ARE THE PROPERTY OF DELTA ELECTRONICS MFG CORP. AND SHALL NOT BE REPRODUCED, OR COPIED OR USED AS THE BASIS FOR THE MANUFACTURE OR SALE OF APPARATUS OR DEVICES WITHOUT THEIR EXPRESS WRITTEN CONSENT.