



OneStep Connectors for semi-rigid cable

ONLINE CATALOG

Faster assembly

Delta's OneStep design eliminates contact soldering and gapping, simplifying your cable assembly process.

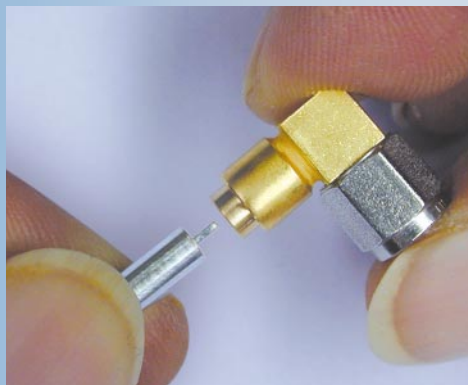

Trim cable and insert into connector.



Solder cable jacket to connector body.



Better performance

OneStep right angle SMA plugs offer the low VSWR of swept body designs without the high cost.

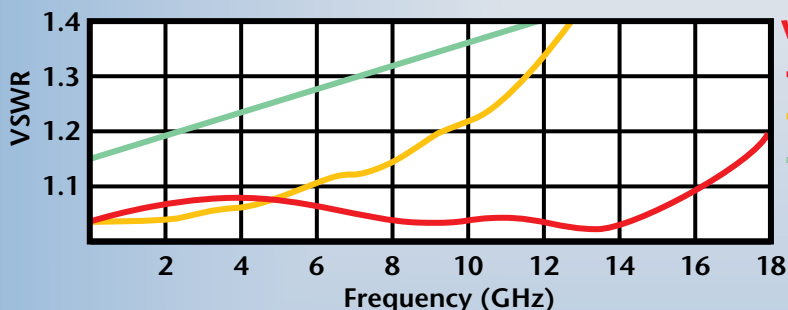

VSWR comparison (.085" semi-rigid)
 — Delta OneStep right angle SMA plug
 — Standard right angle SMA plug
 — MIL-PRF-39012 specification limit

Contents

N OneStep connectors.....	2
SMA OneStep connectors	3
Cable groups, mounting figures, assembly instructions.....	4

**(978) 927-1060 • FAX (978) 922-6430 • www.DeltaRF.com
 P.O. Box 53 • 416 Cabot St. • Beverly, MA 01915**

Straight Plugs

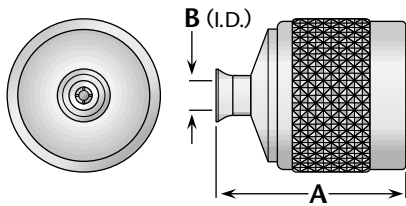

Figure 1
(Standard coupling nut)

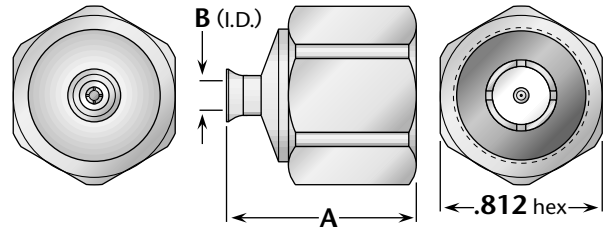

Figure 2
(Hex coupling nut)

Cable Group	Figure	Dimensions		Plating		Delta P/N	Assembly Procedure/ Trim Code
		A	B	Body	Contact		
12	2	1.44	.254	Silver	Gold (C)	1101-050-A003-7	I/01
13	1	.96	.143	Silver	Gold (C)	1101-031-A003-8	I/01
13	2	.96	.143	Silver	Gold (C)	1101-031-A003-12	I/01

Panel Jacks

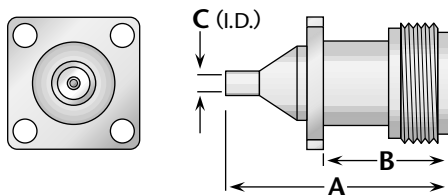

Figure 1

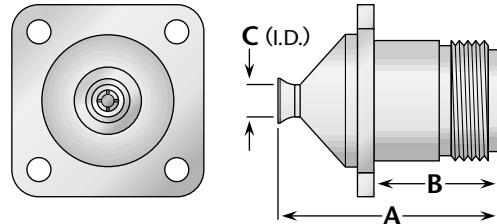
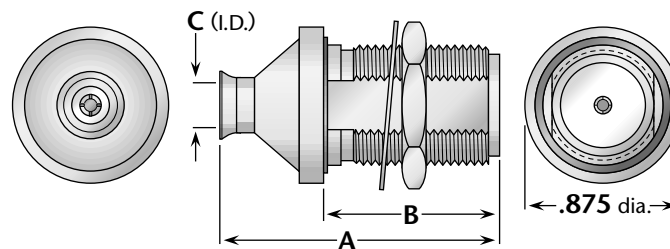

Figure 2

Cable Group	Fig.	Dimensions			Mounting Figure	Plating		Delta P/N	Assembly Procedure/ Trim Code
		A	B	C		Body	Contact		
13	1	1.11	.66	.143	09	Silver	Gold (C)	1111-031-A091-1	I/01
13	2	1.07	.64	.143	33	Silver	Gold (C)	1111-031-A333-4	I/01
14	1	1.11	.66	.088	09	Silver	Gold (C)	1111-025-A091-1	I/01
14	2	1.07	.64	.088	33	Silver	Gold (C)	1111-025-A333-2	I/01

Bulkhead Jacks

Figure 1



Cable Group	Fig.	Dimensions			Mounting Figure	Max. Panel	Plating		Delta P/N	Assembly Procedure/ Trim Code
		A	B	C			Body	Contact		
13	4	1.38	.922	.143	72	.25	Silver	Gold (C)	1116-031-A723-3	I/01
14	4	1.38	.922	.088	72	.25	Silver	Gold (C)	1116-025-A723-2	I/01

(C) in contact plating column indicates captive contact.

See page 4 for cable groups, mounting figures, and assembly procedures.
For specifications and interface dimensions, download the file [DeltaN.pdf](#) from our website.

Straight and Right Angle Plugs



Cable Group	Figure	Dimensions		Plating		Delta P/N	Assembly Procedure/ Trim Code
		A	B	Body	Contact		
13	1	.330	.430	Gold/PCN ⁽¹⁾	Gold (C)	1301-031-K003-8	I/01
13	2	.57	.58	Gold	Gold (C)	1305-031-G003-2	I/01
13	2	.57	.58	Gold/PCN ⁽¹⁾	Gold (C)	1305-031-K003-4	I/01
14	1	.330	.430	Gold/PCN ⁽¹⁾	Gold (C)	1301-094-K003-1	I/01
14	2	.57	.58	Gold	Gold (C)	1305-094-G003-3	I/01
14	2	.57	.58	Gold/PCN ⁽¹⁾	Gold (C)	1305-094-K003-5	I/01

(1) Gold-plated body and passivated coupling nut.

Straight Jacks

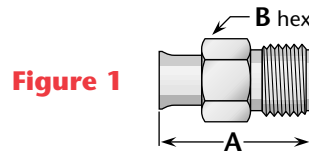

Cable Group	Figure	Dimensions		Plating		Delta P/N	Assembly Procedure/ Trim Code
		A	B	Body	Contact		
13	3	.500	.250	Gold	Gold (C)	1308-031-G003-4	I/01
14	3	.500	.250	Gold	Gold (C)	1308-094-G003-1	I/01

Panel and Bulkhead Jacks

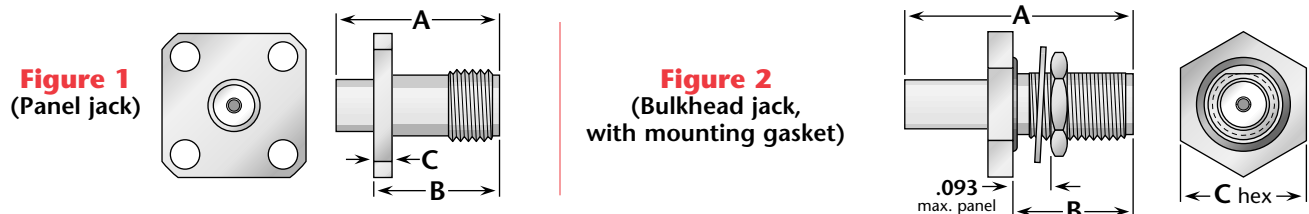

Cable Group	Fig.	Dimensions			Mounting Figure	Plating		Delta P/N	Assembly Procedure/ Trim Code
		A	B	C		Body	Contact		
13	1	.500	.375	.065	05	Gold	Gold (C)	1311-031-G053-3	I/01
13	2	.70	.415	.437	67	Gold	Gold (C)	1317-031-G673-3	I/01
14	1	.500	.375	.065	05	Gold	Gold (C)	1311-025-G053-1	I/01
14	2	.75	.415	.437	67	Gold	Gold (C)	1317-025-G673-1	I/01

(C) in contact plating column indicates captive contact.

See page 4 for cable groups, mounting figures, and assembly procedures.
For specifications and interface dimensions, download the file [DeltaSMA.pdf](#) from our website.

Delta Cable Groups—Semi-Rigid Cable

Group	Cables
12	.250" semi-rigid; RG-401; M17/129
13	.141" semi-rigid; RG-402; M17/130
14	.085" semi-rigid; RG-405; M17/133

Assembly Procedure

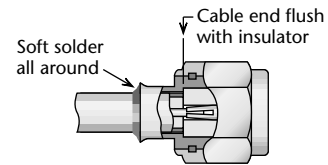
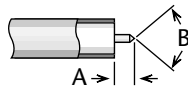
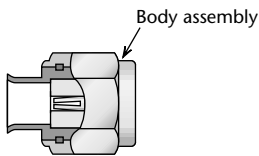

Trim Codes

Code	A	B
I/01	.090	70-90°

- 1) Trim cable as shown. Remove any burrs from jacket and center conductor.

- 2) Insert cable into body and solder cable jacket to body, keeping end of cable flush with insulator as shown.

Plug body assembly and contact shown; procedure is identical for jack connectors.

Connector Flanges (Panel mounted connectors)

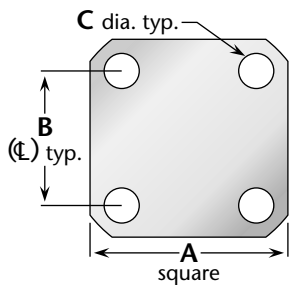

4-hole flanges

Figure	A	B	C
05	1/2	.340	.102
09	11/16	.500	.125
33	1	.718	.125

Panel Cutouts (Bulkhead mounted connectors)

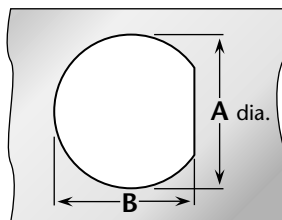

D-Hole

Figure	A	B
67	.255	.236

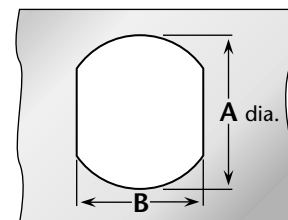

Double D-Hole

Figure	A	B
72	.630	.536